

# THX90

## Helical Square Shoulder Milling Cutters

### The Extended Program:

In addition to the proven helical end mills in the 1" to 2" diameter range, helical shell mills are also available from 2" to 3" diameters with coarse tooth pitches, for low-powered machine tools and slot milling, as well as trimming and shoulder milling.

Our THX90 helical cutters are ideal for rough-milling large grooves and shoulders. Large overall cutting-edge lengths, and the efficient use of each flute, guarantees a wide range of applications and high performance.

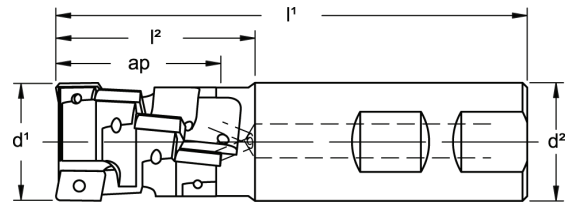

### Helical End Mills with Coolant Through for Profiling & Milling

Designation	d <sup>1</sup>	d <sup>2</sup>	l <sup>1</sup>	l <sup>2</sup>	Max. ap	flutes	No. of inserts	Insert	Insert Screw	Wrench
THXD90-1000	1.000	1.000	4.00	1.72	1.30	2	8	222.79.600 222.79.610	214.80.800	214.80.866 (S/D) 214.80.011 (F/T)
THXD90-1250	1.250	1.250	4.49	2.21	1.30	3	12			
THXD90-1500	1.500	1.250	4.84	2.56	1.61	3	15			
THXP90-1250	1.250	1.250	4.63	2.35	1.15	2	4	222.79.400 222.79.500 222.79.510 222.79.550 222.79.564 222.79.572 222.79.574	214.80.558	214.80.824 (S/D) 214.80.012 (F/T)
THXP90-1250L	1.250	1.250	4.84	2.56	1.70	2	6			
THXP90-1500	1.500	1.250	5.01	2.73	1.17	3	6			
THXP90-1500L	1.500	1.250	5.01	2.73	1.70	3	9			
THXP90-1750	1.750	1.250	5.01	2.73	1.17	3	6			
THXP90-2000EM	2.000	1.250	5.25	2.97	2.25	3	12			

Remember to use COPASLIP® anti-seize compound on all insert screws

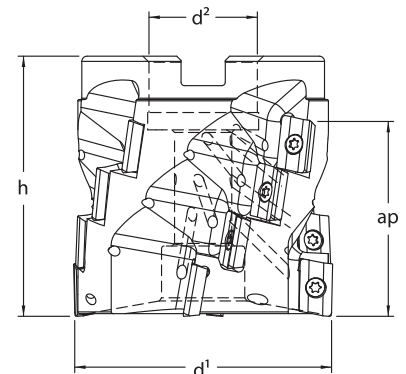
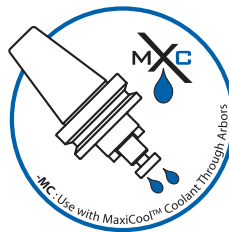

### Helical Shell Mills with Coolant Through for Profiling & Milling

Designation	d <sup>1</sup>	d <sup>2</sup>	h	Max. ap	flutes	No. of inserts	Insert	Insert Screw	Wrench
THXP90-2000-MC	2.000	.750	2.00	1.17	3	6	222.79.400 222.79.500 222.79.510 222.79.550 222.79.564 222.79.572 222.79.574	214.80.558	214.80.824 (S/D) 214.80.012 (F/T)
THXP90-2000L-MC	2.000	.750	2.50	1.65	3	9			
THXP90-2500-MC	2.500	1.000	2.50	1.65	3	9			
THXP90-2500L-MC	2.500	1.000	3.00	2.13	3	12			
THXP90-3000-MC	3.000	1.250	3.00	2.25	4	16			

Remember to use COPASLIP® anti-seize compound on all insert screws

